

## JV241010

**De-Clutchable Gearbox  
with Manual Override  
for  
Pneumatic Actuators**



The JV241010 worm gear gearbox is designed to sandwich in-between a valve and pneumatic actuator to provide manual operation of the valve in the event of a loss of control air supply.

The gearbox has an ISO 5211 interface and has a body constructed of aluminium alloy.

Model	Output Torque	Speed Ratio
JV241010-1	180	26:1
JV241010-2	320	28:1
JV241010-3	380	38:1
JV241010-4	1200	54:1
JV241010-5	2100	80:1
JV241010-6	3000	78:1
JV241010-7	3800	98:1

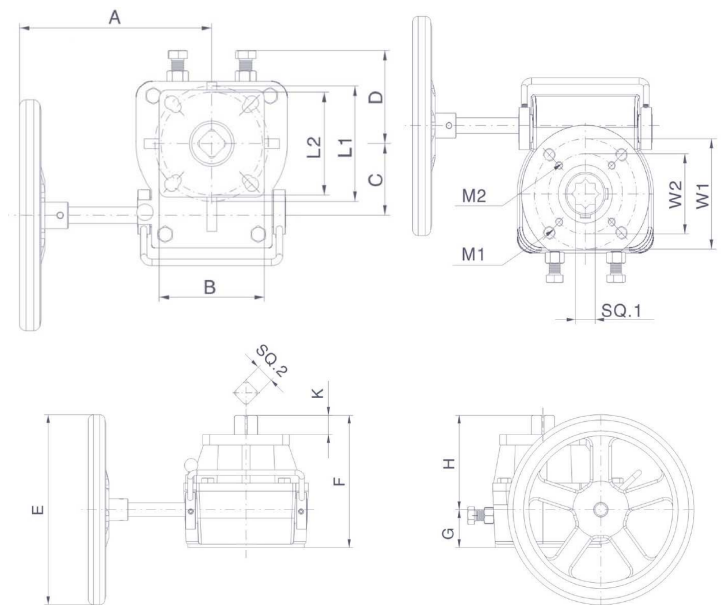

Model	JV241010-1	JV241010-2	JV241010-3	JV241010-4	JV241010-5	JV241010-6	JV241010-7
<b>A</b>	150	170	200	260	310	395	435
<b>B</b>	70	95	115	140	155	160	235
<b>C</b>	50	55	82	85	125	140	170
<b>D</b>	43	65	90	102	110	140	160
<b>E</b>	180	200	280	320	400	500	600
<b>F</b>	120	127	152	193	223	248	248
<b>G</b>	35	40	40	60	55	60	60
<b>H</b>	85	87	110	135	154	172	183
<b>K</b>	15	19	22	28	39	48	55
<b>M1</b>	M8x4	M10x4	M12x4	M16x4	M20x4	M20x4	M20x4
<b>M2</b>	M6x4	M8x4	M10x4	M10x4/M12x4	M16x4	M16x4	-
<b>W1</b>	F07	F10	F12	F14	F16	F16	F16
<b>W2</b>	F05	F07	F10	F10/F12	F14	F14	-
<b>SQ.1</b>	14	17	22	27	36	46	46
<b>L1</b>	F07	F10	F12	F14	F16	F16	F16
<b>L2</b>	F05	F07	F10	F12	F14	-	-
<b>SQ.2</b>	14	17	22	27	36	46	46
<b>Weight Kg</b>	3	4.5	7	13.7	22	30	38